

MIRABELLA AT MIRASOL PLAT "B"

A PORTION OF GOLF DIGEST P.C.D.
 A REPLAT OF A PORTION OF TRACT AA, MIRASOL PLAT ONE, AS RECORDED IN PLAT
 BOOK 89, PAGES 14 THROUGH 23 OF THE PUBLIC RECORDS OF PALM BEACH COUNTY, FLORIDA,
 LYING IN SECTION 34, TOWNSHIP 41 SOUTH, RANGE 42 EAST, CITY OF PALM BEACH GARDENS,
 PALM BEACH COUNTY, FLORIDA

THIS INSTRUMENT PREPARED BY
 DAVID P. LINDLEY
 OF
CAULFIELD and WHEELER, INC.
 SURVEYORS - ENGINEERS - PLANNERS
 7301-A WEST PALMETTO PARK ROAD, SUITE 100A
 BOCA RATON, FLORIDA 33433 - (561)392-1991
 CERTIFICATE OF AUTHORIZATION NUMBER 3591
 FEBRUARY - 2001

ACKNOWLEDGEMENT

STATE OF FLORIDA;
 COUNTY OF PALM BEACH;
 BEFORE ME, PERSONALLY APPEARED DANA HUNTER WHO IS PERSONALLY KNOWN TO ME, OR HAS PRODUCED N/A AS IDENTIFICATION, AND WHO EXECUTED THE FOREGOING INSTRUMENT AS VICE PRESIDENT OF FIRST UNION NATIONAL BANK, A FLORIDA BANKING CORPORATION, AND SEVERALLY ACKNOWLEDGED TO AND BEFORE ME THAT HE/SHE EXECUTED SUCH INSTRUMENT AS SUCH OFFICER OF SAID CORPORATION, AND THAT THE SEAL AFFIXED TO THE FOREGOING INSTRUMENT IS THE CORPORATE SEAL OF SAID CORPORATION AND THAT IT WAS AFFIXED TO SAID INSTRUMENT BY DUE AND REGULAR CORPORATE AUTHORITY, AND THAT SAID INSTRUMENT IS THE FREE ACT AND DEED OF SAID CORPORATION.

WITNESS MY HAND AND OFFICIAL SEAL THIS 30TH DAY OF AUGUST 2001.

MY COMMISSION EXPIRES: 3/12/2006 DATE Sandra L. Lauffer NOTARY

NORTHERN PALM BEACH COUNTY IMPROVEMENT DISTRICT ACKNOWLEDGEMENT, ACCEPTANCE OF DEDICATION AND RELEASE

STATE OF FLORIDA;
 COUNTY OF PALM BEACH;
 THE NORTHERN PALM BEACH COUNTY IMPROVEMENT DISTRICT (NPBCID) HEREBY CONSENTS TO THE RELEASE OF THE UNIT OF DEVELOPMENT NO. 43 BLANKET WATER MANAGEMENT EASEMENT RECORDED IN OFFICIAL RECORD BOOK 12176, PAGE 309 THROUGH 315, PUBLIC RECORDS OF PALM BEACH COUNTY, FLORIDA, AS TO ONLY THAT REAL PROPERTY DESCRIBED IN AND SUBJECT TO THIS PLAT. THE DISTRICT HEREBY ACCEPTS THE DEDICATION OF THE EASEMENTS HEREIN GRANTED TO IT AND ACKNOWLEDGES THAT THERE ARE NO MAINTENANCE OBLIGATIONS BEING INCURRED OR ACCEPTED BY SAID DISTRICT ON THIS PLAT.

DATED THIS 10TH DAY OF SEPTEMBER, 2001.

NORTHERN PALM BEACH COUNTY IMPROVEMENT DISTRICT
 ATTEST: Peter L. Pimentel BY: Sally Hamadeh
 PETER L. PIMENTEL, SECRETARY A. SALLY HAMADEH, PRESIDENT
 BOARD OF SUPERVISORS BOARD OF SUPERVISORS

ACCEPTANCE OF RESERVATIONS

STATE OF FLORIDA;
 COUNTY OF PALM BEACH;
 MIRABELLA AT MIRASOL HOMEOWNERS ASSOCIATION, INC., A FLORIDA CORPORATION, NOT FOR PROFIT, HEREBY ACCEPTS THE DEDICATIONS OR RESERVATIONS TO SAID ASSOCIATION AS STATED AND SHOWN HEREON, AND HEREBY ACCEPTS ITS MAINTENANCE OBLIGATIONS FOR SAME AS STATED HEREON, DATED THIS 29TH DAY OF AUGUST, 2001.

MIRABELLA AT MIRASOL HOMEOWNERS ASSOCIATION, INC., A FLORIDA CORPORATION NOT FOR PROFIT
 WITNESS: Julie Streetor BY: Dean J. Borg
 PRINT NAME: Julie Streetor DEAN J. BORG
 PRESIDENT
 WITNESS: Janice E. Potts
 PRINT NAME: Janice E. Potts

ACKNOWLEDGEMENT

STATE OF FLORIDA;
 COUNTY OF PALM BEACH;
 BEFORE ME, PERSONALLY APPEARED DEAN J. BORG WHO IS PERSONALLY KNOWN TO ME, OR HAS PRODUCED N/A AS IDENTIFICATION, AND WHO EXECUTED THE FOREGOING INSTRUMENT AS PRESIDENT OF MIRABELLA AT MIRASOL HOMEOWNERS ASSOCIATION, INC., A FLORIDA CORPORATION, NOT FOR PROFIT, AND SEVERALLY ACKNOWLEDGED TO AND BEFORE ME THAT HE EXECUTED SUCH INSTRUMENT AS SUCH OFFICER OF SAID CORPORATION, AND THAT THE SEAL AFFIXED TO THE FOREGOING INSTRUMENT IS THE CORPORATE SEAL OF SAID CORPORATION AND THAT IT WAS AFFIXED TO SAID INSTRUMENT BY DUE AND REGULAR CORPORATE AUTHORITY, AND THAT SAID INSTRUMENT IS THE FREE ACT AND DEED OF SAID CORPORATION.

WITNESS MY HAND AND OFFICIAL SEAL THIS 29 DAY OF AUGUST 2001.

MY COMMISSION EXPIRES: 9-23-2002 DATE Nancy O'Brien NOTARY PUBLIC

FIRST UNION NATIONAL BANK NOTARY



FIRST UNION NATIONAL BANK



MIRASOL MASTER MAINTENANCE ASSOCIATION, INC.



MIRASOL MASTER MAINTENANCE ASSOCIATION, INC. NOTARY



MIRABELLA AT MIRASOL HOMEOWNERS ASSOCIATION, INC.



MIRABELLA AT MIRASOL HOMEOWNERS ASSOCIATION, INC. NOTARY



NORTHERN PALM BEACH COUNTY IMPROVEMENT DISTRICT



SURVEYOR



CITY OF PALM BEACH GARDENS



REVIEWING SURVEYOR



TITLE CERTIFICATION

STATE OF FLORIDA;
 COUNTY OF PALM BEACH;
 I, GARY S. DUNAY, A DULY LICENSED ATTORNEY IN THE STATE OF FLORIDA, DO HEREBY CERTIFY THAT I HAVE EXAMINED THE TITLE TO THE HERON DESCRIBED PROPERTY; THAT I FIND THE TITLE TO THE PROPERTY IS VESTED TO KENCO COMMUNITIES AT MIRASOL, INC., A FLORIDA CORPORATION, THAT THE CURRENT TAXES HAVE BEEN PAID; THAT ALL MORTGAGES OF RECORD NOT SATISFIED OR RELEASED OF RECORD NOR OTHERWISE TERMINATED BY LAW ARE SHOWN HEREON; AND THAT THERE ARE ENCUMBRANCES OF RECORD BUT THOSE ENCUMBRANCES DO NOT PROHIBIT THE CREATION OF THE SUBDIVISION DEPICTED BY THIS PLAT.

DATE: August 31, 2001 BY: Gary S. Dunay
 GARY S. DUNAY
 ATTORNEY AT LAW
 LICENSED IN FLORIDA

SURVEYOR'S NOTES

- ALL BEARINGS SHOWN HEREON ARE BASED ON A BEARING OF SOUTH 01° 34' 15" WEST ALONG THE EAST LINE OF TRACT AA, MIRASOL PLAT ONE, AS RECORDED IN PLAT BOOK 89, PAGES 14 THROUGH 23 OF THE PUBLIC RECORDS OF PALM BEACH COUNTY, FLORIDA.
- NO BUILDINGS OR ANY KIND OF CONSTRUCTION OR TREES OR SHRUBS SHALL BE PLACED ON ANY EASEMENT WITHOUT PRIOR WRITTEN APPROVAL OF ALL EASEMENT BENEFICIARIES AND ALL APPLICABLE CITY OR COUNTY APPROVALS OR PERMITS AS REQUIRED FOR SUCH IMPROVEMENTS.
- IN THOSE CASES WHERE EASEMENTS OF DIFFERENT TYPES CROSS, DRAINAGE EASEMENTS SHALL HAVE FIRST PRIORITY, UTILITY EASEMENTS SHALL HAVE SECOND PRIORITY, ACCESS EASEMENTS SHALL HAVE THIRD PRIORITY, AND ALL OTHER EASEMENTS SHALL BE SUBORDINATE TO THESE WITH THEIR PRIORITIES BEING DETERMINED BY THE USE RIGHTS GRANTED. THERE SHALL BE NO LANDSCAPE OR ABOVE GROUND ENCROACHMENTS WHERE LANDSCAPE TRACTS OR EASEMENTS COINCIDE WITH MAINTENANCE EASEMENTS OR LAKE MAINTENANCE ACCESS EASEMENTS.
- ALL LINES WHICH INTERSECT CURVES ARE RADIAL TO THOSE CURVES UNLESS OTHERWISE NOTED.
- THE BUILDING SETBACK LINE SHALL BE AS REQUIRED BY CURRENT CITY OF PALM BEACH GARDENS ZONING REGULATIONS.

SURVEYOR'S CERTIFICATION

THIS IS TO CERTIFY THAT THE PLAT SHOWN HEREON WAS PREPARED UNDER MY DIRECTION AND SUPERVISION AND IS A TRUE AND CORRECT REPRESENTATION OF A SURVEY MADE UNDER MY RESPONSIBLE DIRECTION AND SUPERVISION. THAT SAID SURVEY IS ACCURATE TO THE BEST OF MY KNOWLEDGE AND BELIEF; THAT PERMANENT REFERENCE MONUMENTS (P.R.M.'S) HAVE BEEN PLACED AS REQUIRED BY LAW, AND THAT PERMANENT CONTROL POINTS (P.C.P.'S) AND MONUMENTS ACCORDING TO SECTION 177.091(9), F.S., WILL BE SET UNDER THE GUARANTEES POSTED WITH THE CITY OF PALM BEACH GARDENS FOR THE REQUIRED IMPROVEMENTS; AND, FURTHER, THAT THE SURVEY DATA COMPLIES WITH ALL THE REQUIREMENTS OF CHAPTER 177, FLORIDA STATUTES, AS AMENDED, AND THE ORDINANCES OF THE CITY OF PALM BEACH GARDENS, FLORIDA.

THIS 31ST DAY OF AUGUST, 2001.

David P. Lindley
 DAVID P. LINDLEY, P.L.S.
 REG. LAND SURVEYOR #5005
 STATE OF FLORIDA
 LB #3591

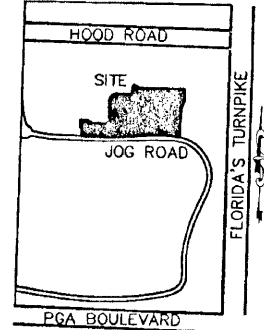

LOCATION MAP NOT TO SCALE

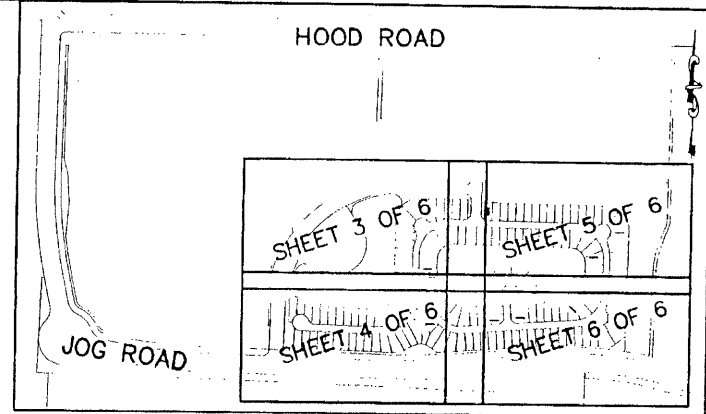

LOCATION/KEY MAP NOT TO SCALE

29

STATE OF FLORIDA
 COUNTY OF PALM BEACH
 THIS PLAT WAS FILED FOR RECORD AT _____ M.
 THIS _____ DAY OF _____
 A.D. 2001 AND DULY RECORDED IN PLAT BOOK _____ ON PAGES _____ AND _____
 DOROTHY H. WILKEN
 CLERK CIRCUIT COURT
 BY: _____
 DEPUTY CLERK

SHEET 2 OF 6

P.C.D. TABULAR DATA Parcel "B"

LOT	ACRES	LAND USE	CODE	61	0.13	SFP	121	0.14	SFP
1	0.15	SFP	67	0.13	SFP	122	0.18	SFP	
2	0.13	SFP	68	0.13	SFP	123	0.17	SFP	
3	0.13	SFP	69	0.13	SFP	124	0.21	SFP	
4	0.13	SFP	70	0.13	SFP	125	0.20	SFP	
5	0.13	SFP	71	0.13	SFP	126	0.22	SFP	
6	0.13	SFP	72	0.13	SFP	127	0.19	SFP	
7	0.13	SFP	73	0.13	SFP	128	0.16	SFP	
8	0.13	SFP	74	0.13	SFP	129	0.20	SFP	
9	0.13	SFP	75	0.13	SFP	130	0.13	SFP	
10	0.13	SFP	76	0.13	SFP	131	0.16	SFP	
11	0.13	SFP	77	0.13	SFP	132	0.13	SFP	
12	0.13	SFP	78	0.13	SFP	133	0.16	SFP	
13	0.13	SFP	79	0.13	SFP	134	0.14	SFP	
14	0.13	SFP	80	0.13	SFP	135	0.13	SFP	
15	0.13	SFP	81	0.13	SFP	136	0.13	SFP	
16	0.13	SFP	82	0.13	SFP	137	0.16	SFP	
17	0.20	SFP	83	0.13	SFP	138	0.19	SFP	
18	0.16	SFP	84	0.13	SFP	139	0.19	SFP	
19	0.19	SFP	85	0.15	SFP	140	0.19	SFP	
20	0.14	SFP	86	0.20	SFP	141	0.13	SFP	
21	0.13	SFP	87	0.20	SFP	142	0.13	SFP	
22	0.13	SFP	88	0.15	SFP	143	0.13	SFP	
23	0.14	SFP	89	0.15	SFP	144	0.18	SFP	
24	0.13	SFP	90	0.14	SFP	145	0.19	SFP	
25	0.13	SFP	91	0.14	SFP	146	0.19	SFP	
26	0.13	SFP	92	0.13	SFP	147	0.19	SFP	
27	0.14	SFP	93	0.15	SFP	148	0.13	SFP	
28	0.15	SFP	94	0.16	SFP	149	0.13	SFP	
29	0.22	SFP	95	0.14	SFP	150	0.13	SFP	
30	0.21	SFP	96	0.23	SFP	151	0.13	SFP	
31	0.27	SFP	97	0.24	SFP	152	0.13	SFP	
32	0.17	SFP	98	0.17	SFP	153	0.13	SFP	
33	0.15	SFP	99	0.18	SFP	154	0.13	SFP	
34	0.14	SFP	100	0.16	SFP	155	0.13	SFP	
35	0.13	SFP	101	0.15	SFP	156	0.13	SFP	
36	0.13	SFP	102	0.15	SFP	157	0.13	SFP	
37	0.13	SFP	103	0.15	SFP	158	0.13	SFP	
38	0.13	SFP	104	0.13	SFP	159	0.13	SFP	
39	0.13	SFP	105	0.16	SFP	Tract A	5.57	EXM	
40	0.13	SFP	106	0.16	SFP	Tract L1	0.23	EXM	
41	0.13	SFP	107	0.19	SFP	Tract L2	0.05	EXM	
42	0.13	SFP	108	0.17	SFP	Tract L3	0.18	EXM	
43	0.13	SFP	109	0.18	SFP	Tract L4	1.00	EXM	
44	0.13	SFP	110	0.18	SFP	Tract W	6.03	EXM	
45	0.13	SFP	111	0.14	SFP	Tract W1	8.15	EXM	
46	0.13	SFP	112	0.13	SFP				
47	0.13	SFP	113	0.13	SFP				
48	0.13	SFP	114	0.17	SFP				
49	0.15	SFP	115	0.18	SFP				
50	0.17	SFP	116	0.19	SFP				
51	0.21	SFP	117	0.17	SFP				
52	0.17	SFP	118	0.14	SFP				
53	0.18	SFP	119	0.15	SFP				
54	0.21	SFP	120	0.17	SFP				
55	0.17	SFP							
56	0.17	SFP							
57	0.17	SFP							
58	0.20	SFP							
59	0.16	SFP							
60	0.14	SFP							